

Penstock Selection Form

Custom: _____ Address: _____
 Project: _____ No. of armatures: _____

1 Size and design of orifice

round rectangular semicircle

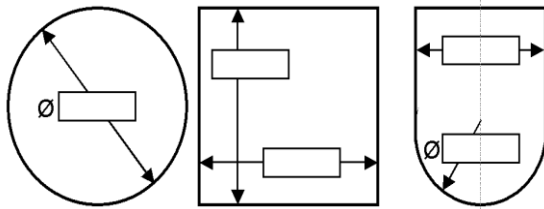

Please give all dimensions in mm

2 pressure requirements

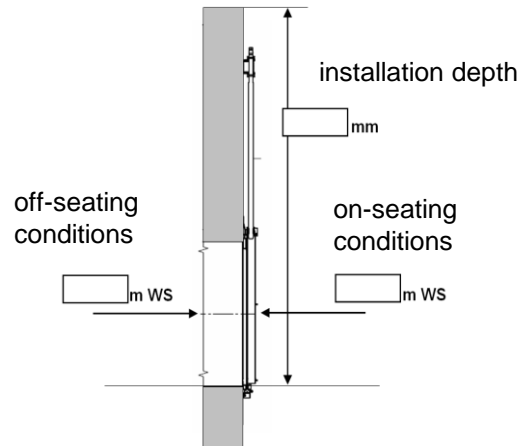

3 installation conditions

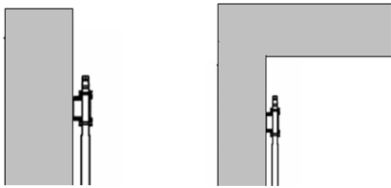

open basin closed chamber

mounting to the pit wall

mounting in a round chamber DN _____

4 installation

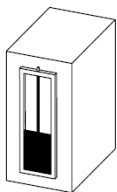

doweling lateral & on the bottom

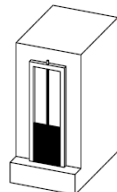

doweling lateral & bottom in concrete

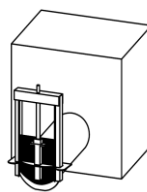

mounting to a flange connection

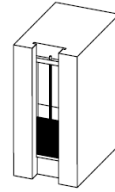

lateral in concrete, doweling in the bottom

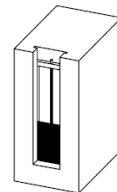

lateral and bottom in concrete

5 function

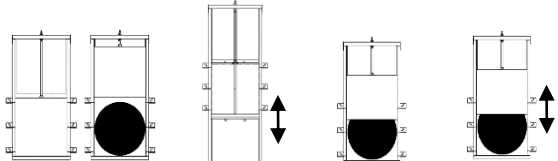

open-close lowering/weir - type throttling regulation

6 sealing performance

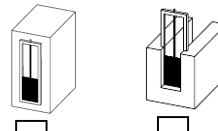

4-side sealing 3-side sealing

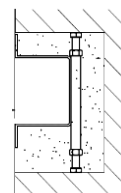

Installation aid for lateral embedding necessary

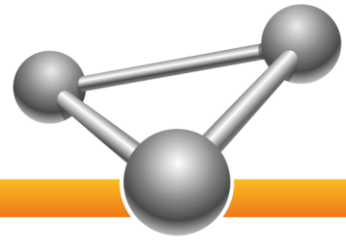

Penstock Selection Form, page 2

7 Materials:



Steel:

- stainless steel SS304
- stainless steel SS316Ti
- other: _____

sealing:

- EPDM
- NBR
- other: _____

8 operating mode

- manual operated:
-  stem square cap, square: _____ mm
 -  hand wheel
- electrical:
- available voltage: _____ V no of phases: _____
- maximum available power: _____ kW
- pneumatic: available operating pressure: _____ bar
- hydraulic: available operating pressure: _____ bar

9 actuating:

- over ground
- under floor
- directly mounted on penstock
- perpendicular to the penstock
- mounted with offset to the penstock
offset: _____ mm



10 spindle

- compact-design
- modular design
- spindle out of the medium
- rising
- non-rising
- position indicator
- headstock with integrated position indicator
- VARIO position indicator

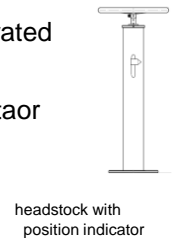
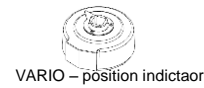
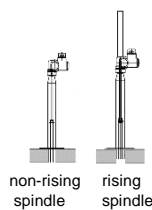
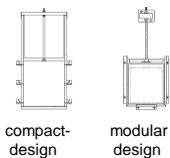

remarks:

Phone-No. / eMail (for an inquiry call):

Send to:
BÜSCH Technology GmbH
Fax: +49 (911) 46254-70
eMail: info@buesch.com