



XM4 penstock

made of stainless steel

WITH RECTANGULAR OPENING, 4-SIDED SEALING

Opening dimensions and pressure stage

- Opening dimensions 200 x 200 mm to 1000 x 1000 mm;
Pressure stage both sides: 10 mWS
- Opening dimensions 1100 x 1100 mm to 1200 x 1200 mm;
Pressure stage both sides: 6 mWS
- Opening dimensions 1300 x 1300 mm bis 4000 x 4000 mm;
Pressure stage both sides to: 2/4/6 mWS

Frame and panel

- Supplied as pre-assembled fitting which does not require assembly, setting and adjusting works up to 1200 mm
- Design as self-supporting frame construction made of stainless steel with integrated spindle bearing
- Welded frame and slide panel made of stainless steel, optimised for maximum safety and durability by means of FEM certification
- Bridge screwed on, thereby all wear parts (spindle, spindle nut, spindle bearing and seal) can be exchanged in the installed condition without dismantling the fitting from the structure
- No offset in rear to front invert level on the embedded penstock

Material

- Stainless steel 1.4301 (304) / 1.4404 (316L) / 1.4410 (507) / 1.4462 (316LN) / 1.4539 (904L)

Spindle

- Spindle protection made of polyethylen pipe
- Spindle with rolled trapezoidal thread made of stainless steel for opening dimensions 200-1700 mm
- Spindle with whirled trapezoidal thread made of stainless steel from opening dimensions 1800-4000 mm
- Single spindle design or twin spindle design
- Spindle nut made of seawater- and wastewater-resistant bronze

Seal

- Assembled on the sliding plate, twin-lipped seal with welded BÜSCH UNO jointed connections made from wastewater- and UV-resistant EPDM or oil-resistant NBR
- Base seal is located on the slider plate
- Waterproofing to wall as optional, to be ordered, sealing compound (Sikaflex)
- Seal line 50 mm larger than the masonry opening to prevent leaks on masonry spalling

Leak tightness class

- Leak rate according to DIN EN 19569, Part 4, Table 1:
Pressure on front side: 0.02 to $0.051 \text{ l} \cdot \text{s}^{-1} \cdot \text{m}^{-1}$ (leak tightness class 4)
Pressure on rear side: 0.05 to $0.1 \text{ l} \cdot \text{s}^{-1} \cdot \text{m}^{-1}$ (leak tightness class 3)
- XM4 penstock leak rate:
Pressure on front side: max. 1 % von $0.02 \text{ l} \cdot \text{s}^{-1} \cdot \text{m}^{-1}$ (leak tightness class 5)
Pressure on rear side: max. 5 % von: 0.02 to $0.05 \text{ l} \cdot \text{s}^{-1} \cdot \text{m}^{-1}$ (leak tightness class 4)

*(multiple frame as of 1300 mm)



XM4 penstock 600 x 600 mm

i

YOUR ADVANTAGES

- **READY FOR IMMEDIATE USE**
Penstock is delivered ready for assembly*
- **CLEAR CONTROL OPTIONS**
Seal is completely in place even in the intermediate position
- **LARGER SEALING LINE**
Ideal for unclean building openings
- **WEAR-FREE BOTTOM LINE**
Bottom seal mounted on the slide panel
- **PERFECT CORROSION PROTECTION**
All welded stainless steel parts from our own pickling plant
- **EX-PROTECTION OPTIONAL**
On request, proven to comply with ATEX directive 2014/35/EU

Mounting

- Lateral fixing
Concreted into recess
Dowelling to the wall in front of the opening
- Fastening in the base
Concreted into recess
Dowelling to the wall in front of the opening
Dowelling onto the base

Actuation of the penstock by

- Stainless steel handwheel on transverse yoke
- Lateral actuation with gearbox with BÜSCH stainless steel gearbox with stainless steel handwheel or stainless steel crank handle
- BÜSCH All-in-one control key via square cap
- BÜSCH MOBITORQ mobile electric actuator via square cap
- BEA® servo electric actuator assembled on transverse yoke
- Optional: BÜSCH weather protection roof
- Pneumatic drive unit assembled on transverse yoke
- Hydraulic drive unit assembled on transverse yoke
- E-actuator

Dimensional drawing

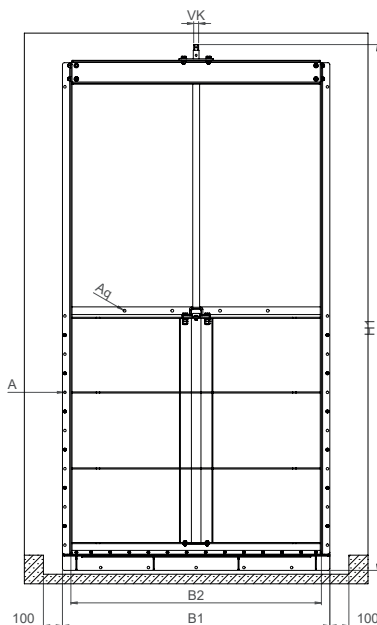

XM4 1200 x 1200 front view

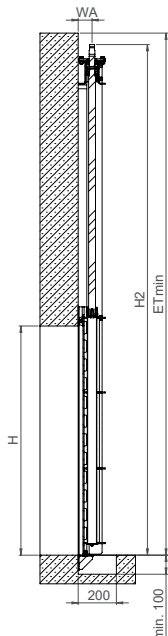

XM4 1200 x 1200 side view

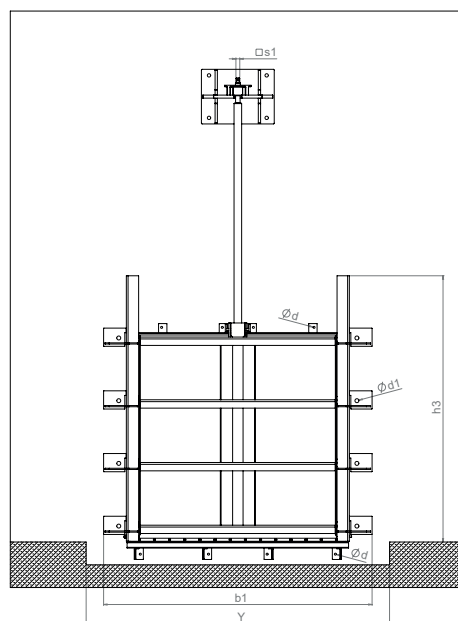

XM4 1300-4000 front view

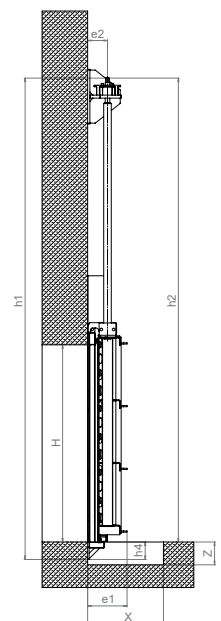

XM4 1300-4000 side view

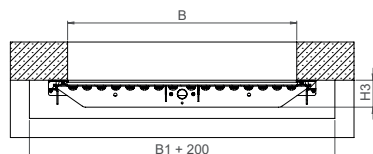

XM4 1200 x 1200 top view

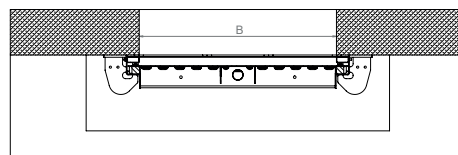

XM4 1300-4000 top view

Dimensions in mm

B x H	200 x 200	300 x 300	400 x 400	500 x 500	600 x 600	700 x700	800 x 800	900 x 900	1000 x 1000	1200 x 1200
B1	400	500	600	700	800	900	1000	1100	1200	1400
B2	312	412	512	612	712	812	912	1012	1112	1312
H1	730	930	1130	1330	1530	1754	1954	2154	2354	2754
H2	650	850	1050	1250	1450	1674	1874	2074	2274	2674
H3	125	125	125	125	125	141	141	141	141	141
ET min.	590	790	990	1190	1390	1614	1814	2014	2214	2614
WA	73	73	73	73	73	73	73	73	73	73
Rev./Stroke	41	61	81	101	121	141	161	181	201	241
VK	□16	□16	□16	□16	□16	□26	□26	□26	□26	□26
A	"5x Ø13 M10x130"	"6x Ø13 M10x130"	"8x Ø13 M10x130"	"9x Ø13 M10x130"	"13x Ø13 M10x130"		"16x Ø13 M10x130"		"19x Ø13 M10x130"	"21x Ø13 M10x130"
Aq	"2x Ø15 M12x160"				"3x Ø15 M12x160"	"4x Ø15 M12x160"				

Dimensions for other nominal sizes on request.